

FRONT VIEW

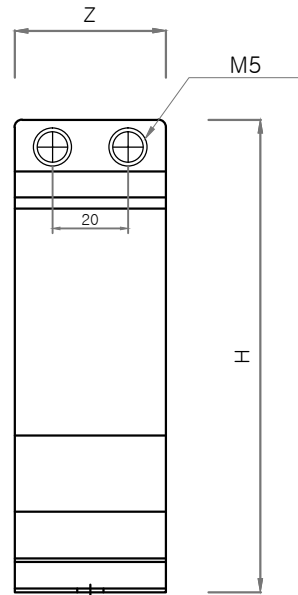

SIDE VIEW

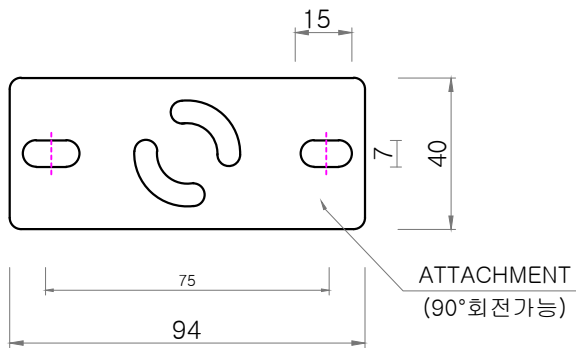

정격/Rating

적용규격 / Standard	KSC 1706
최고전압 / Max Voltage	1.15Kv
정격과 전류 / Over Current Factor	40In/ 1Sec
주 파 수 / Frequency	50/60 Hz

제원 / Dimensions

Model	H	L	W	Z	Weight(g)
CD-20S	85	27	70	36	≒ 350
CD-201	92	25	70	40	≒ 500
CD-202	110	40	88	40	≒ 700
CD-202A	110	40	88	50	≒ 1000
CD-203	125	60	106	40	≒ 800

Daeboong
주)대봉 E&C

PROJEC TTITLE

계기용 변류기

CHK'D BY

SCALE 1 : 2

DRAWING TITLE

B.C.C NO

JOB NO

REV NO

CHK'D BY

DATE 2008. 5. 8

Ring Type

DRWG NO

SHEET NO

CHK'D BY

DRWN BY

08