

TOP VIEW

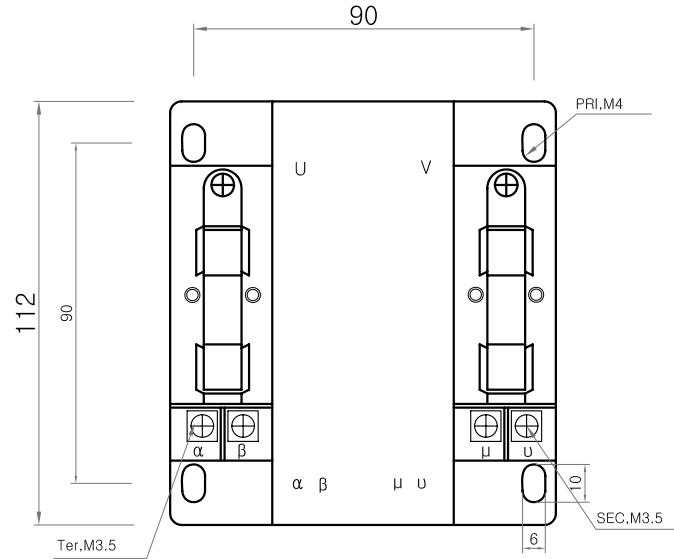

FRONT VIEW

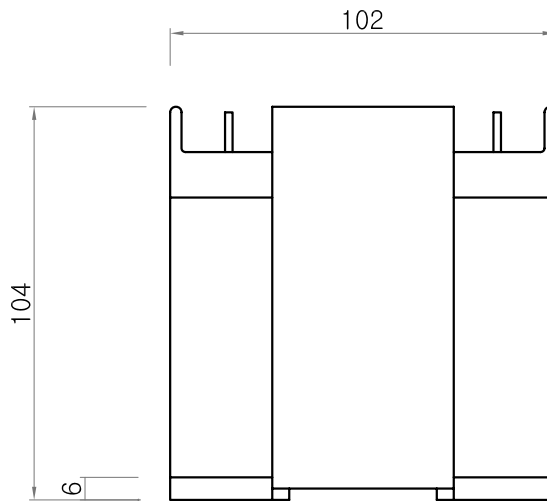

PT정격/Rating

적용규격 / Standard	KSC 1706
최고전압 / Max Voltage	0.46Kv
정밀계급 / Accuracy Class	1.0
1차전압 / Primary Voltage(V)	220~440, 380/√3
2차전압 / Secondary Voltage(V)	110, 190/√3
주파수 / Frequency	50/60 Hz

Daeboong
(주)대봉 E&C

PROJECT TITLE

계기용 변압기

CHK'D BY	SCALE	1 : 2
CHK'D BY	DATE	2008. 5. 8
CHK'D BY	DRWN BY	

DRAWING TITLE
DP-102,10G,103

B.C.C NO	JOB NO	REV NO
DRWG NO	SHEET NO 07	