

TOP VIEW

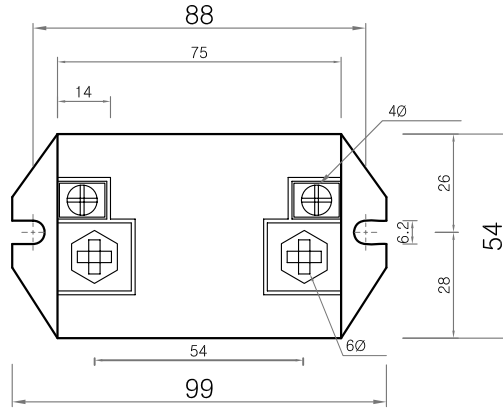

FRONT VIEW

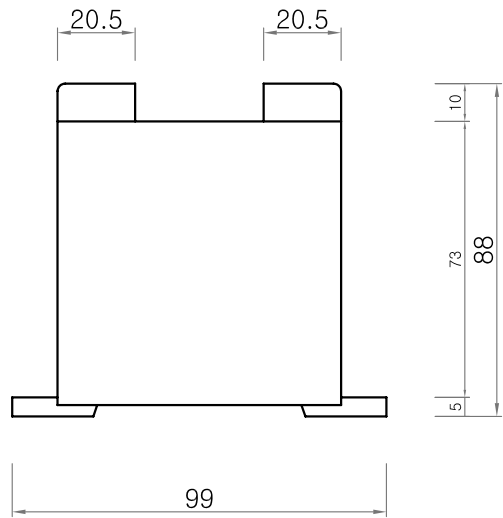

정격/Rating

| | |
|------------------------------|-----------|
| 전용규격 / Standard | KSC 1706 |
| 최고전압 / Max Voltage | 1.15Kv |
| 정격부담 / Rated Burden | 5~40VA |
| 정밀계급 / Accuracy Class | 1.0~3.0 |
| 정격과 전류 / Over Current Factor | 40In/1Sec |
| 주파수 / Frequency | 50~60Hz |
| 2차전류 / Secondary Current | 5 |

Daeboong
(주)대봉 E&C

PROJECT TITLE

터미널 C.T

CHK'D BY

SCALE 1 : 2

DRAWING TITLE

B.C.C NO

JOB NO

REV NO

CHK'D BY

DATE 2008. 5. 8

터미널 C.T

DRWG NO

SHEET NO

CHK'D BY

DRWN BY

05